

Happy D.2 Toilet seat # 006459..00 / 006459..00

| < 359 mm > |

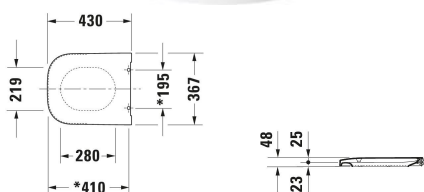
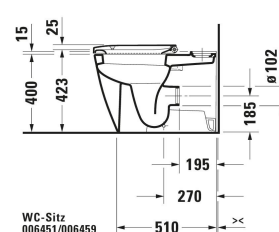
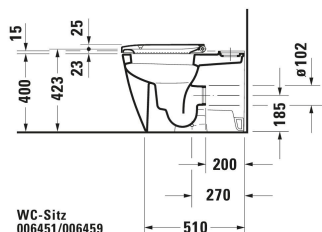

Toilet seat	Dimension	Weight	Order number
Shape: Rectangular, Automatic close: Yes, Removable Seat, Hinge material: Stainless steel			
Colors			
00 White Alpin 13 Anthracite Matt			
Variant			
Shape: D-shaped, White High Gloss, Hinge colour: Stainless steel, Wrap over		2.400 kg	006459..00
Anthracite Matt, Hinge colour: Anthracite, Wrap over		2.600 kg	006459..00
Suitable products			
Wall-mounted toilet Flush water quantity: 4,5/3 l, Washdown model, Flushing rim: Closed, Flush principle: washdown model, Outlet drain horizontal, Incl. invisible fixation, Unified Water Label (UWL) Class: 1, 365 x 540 mm	365 x 540 mm		222109
Floorstanding toilet Back to wall version, Flush water quantity: 4,5/3 l, Washdown model, Flushing rim: Closed, Outlet drain: horizontal, Position outlet: Back, Flush principle: washdown model, Incl. mounting material, Unified Water Label (UWL) Class: 1, 365 x 570 mm	365 x 570 mm		215909
Toilet close-coupled Flush water quantity: 4,5/3 l, Washdown model, Flushing rim: Closed, Outlet drain: horizontal, vertical, Position outlet: Back, Incl. cistern: No, Flush principle: extractor/siphon jet, For bowl mounted cistern, Length adjustable, Incl. mounting material, Outlet dimensions for Vario connecting bend vertical: 70 - 170 mm, Outlet dimensions for Vario outlet set vertical/horizontal: 155 - 210 mm, Unified Water Label (UWL) Class: 1, 365 x 630 mm	365 x 630 mm		213409

Happy D.2 Toilet seat # 006459..00 / 006459..00

|< 359 mm >|

Wall-mounted toilet Flush water quantity: 4,5/3 l, Washdown model, Flushing rim: Rimless, Flush principle: washdown model, Outlet drain horizontal, Incl. invisible fixation, Unified Water Label (UWL) Class: 1, 365 x 540 mm

365 x 540 mm

222209

All drawings contain the necessary measurements which are subject to standard tolerances. They are stated in mm and are non-binding. Exact measurements, in particular for customised installation scenarios, can only be taken from the finished piece.