

MEISTERSTÜCK CONODUO

- freestanding bath made of KALDEWEI steel enamel
- with exclusive easy-clean finish
- straightlined, purist design
- classic four-cornered model
- enamelled waste cover integrated in the bath design (also available with filling function)
- bathing with a friend: two identical back rests and centrally positioned waste
- designed by Sottsass Associati
- **30 YEAR WARRANTY**

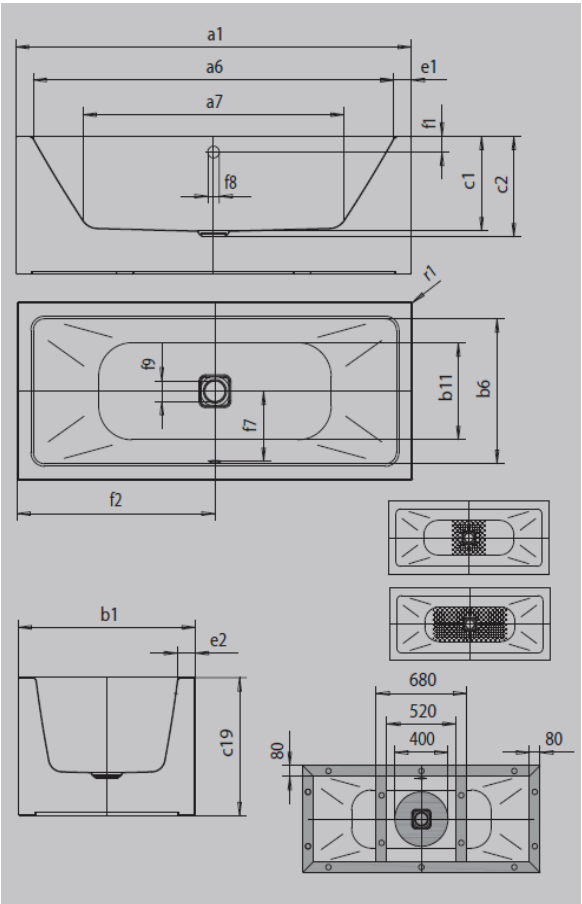

Model No.		1732	1733
External length	a ₁	1700	1800 mm
Internal length (top)	a ₆	1540	1640 mm
Internal length (bottom)	a ₇	1080	1180 mm
External width	b ₁	750	800 mm
Internal width (top)	b ₆	590	640 mm
Internal width (bottom)	b ₁₁	470	520 mm
Depth inside	c ₁	420	420 mm
Depth incl. waste hole	c ₂	445	445 mm
Height of bath	c ₁₉	610	610 mm
Width of rim (foot end; long side)	e ₁ ; e ₂	80; 80	80; 80 mm
Distance top edge to centre of overflow hole	f ₁	70	70 mm
Distance bath edge to centre of waste hole	f ₂	850	900 mm
Distance centre of waste hole to centre of overflow hole	f ₇	285	310 mm
Diameter of overflow hole	f ₈	Ø 52	Ø 52 mm
Diameter of waste hole	f ₉	Ø 90	Ø 90 mm
External radius	r ₁	5	5 mm
Water volume		122	159 l
Waste connection diameter		Ø 40/50	Ø 40/50
Fill fitting connection		1/2"	1/2"
Net weight		154	170 kg
Anti-slip		356 x 356	404 x 404 mm
Full anti-slip		788 x 356	884 x 404 mm

Subject to technical alterations, tolerances and errors. Similar illustrations.
 ** 70 litres displacement on average.