**TECESquare II metal toilet flush plate for dual-flush system**

Article number: 9240830

Colour: Brushed stainless steel (with anti-fingerprint)

Exhibition samples: Yes

DU 1: 1 pc.

DU 2: 10 pc.

**Description:**

Flush plate for TECE cisterns, for front or top actuation. Extra-flat metal flush plate with two spring-mounted actuation rocker buttons. Incl. actuation rods, mounting material and disassembly tool. Compatible with insert chute for cleaning tablets.

Dimensions (W x H x D): 220 x 150 x 3 mm

**Note:**

Ensure minimum wall finish of 30 mm in brick-wall construction!

**Sales data:**

Product name: TECESquare II metal toilet flush plate, brushed stainless steel (with anti-fingerprint), dual-flush system  
Commodity group: 904  
Product group: 2009040070

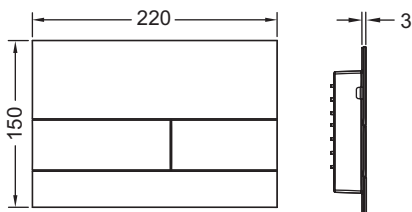
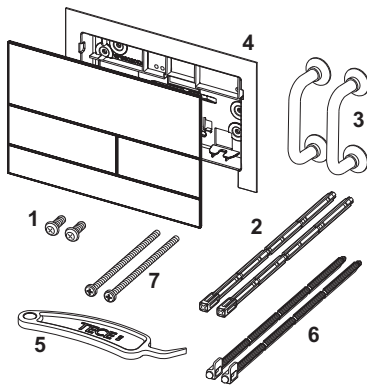
**Spare parts:**

- |   |         |  |
|---|---------|--|
| 1 | 9820263 | Fastening screws (2003-2020)             |
| 2 | 9820022 | Actuation rods (2003-2020)               |
| 3 | 9820180 | Bow-type handles                         |
| 4 | 9820347 | Support frame                            |
| 5 | 9820390 | Dismounting and programming key          |
| 6 | 9820498 | "easy fit" actuation rods (from 2021)    |
| 7 | 9820497 | "easy fit" attachment screws (from 2021) |