

EXPOSED COMBINATION SHOWER SET WITH INTEGRATED DIVERTER

3 STAR/9Lpm WELS RATING

INSTALLATION TO SUIT:

A67.25	A67.25.LH	A68.25.KN
A67.25.V2	A67.25.V2.LH	A68.25.V2.KN
A67.25.V3	A67.25.V3.LH	A68.25.V3.KN
A67.25.V4	A67.25.V4.LH	A68.25.V4.KN

Important - Flush water lines on new installations before fitment to avoid damage to shower
This shower has been designed to operate where the water inlet temperature does not exceed 75°C and water pressure does not exceed 500kpa. Recommended working water pressure 150 - 500kPa.
Please exercise care during installation to ensure the male connecting threads do not damage the flow controllers incorporated.

- 1) Select desired height of overhead shower. Use Spec sheet to determine the required location of the water supply.
- 2) Tighten back 1/2" tail and flange to the female 1/2" in-wall thread
- 3) Tighten the tap body to the flange component using the nut and supplied fiber washer
- 4) Mark-up positioning for the support bracket on the wall.
- 5) Insert wall plugs & secure brass fixing bush to wall using screws supplied.
- 6) Secure riser pipe through the support bracket and secure to the tap body.
- 7) Attach rose, hose & hand shower

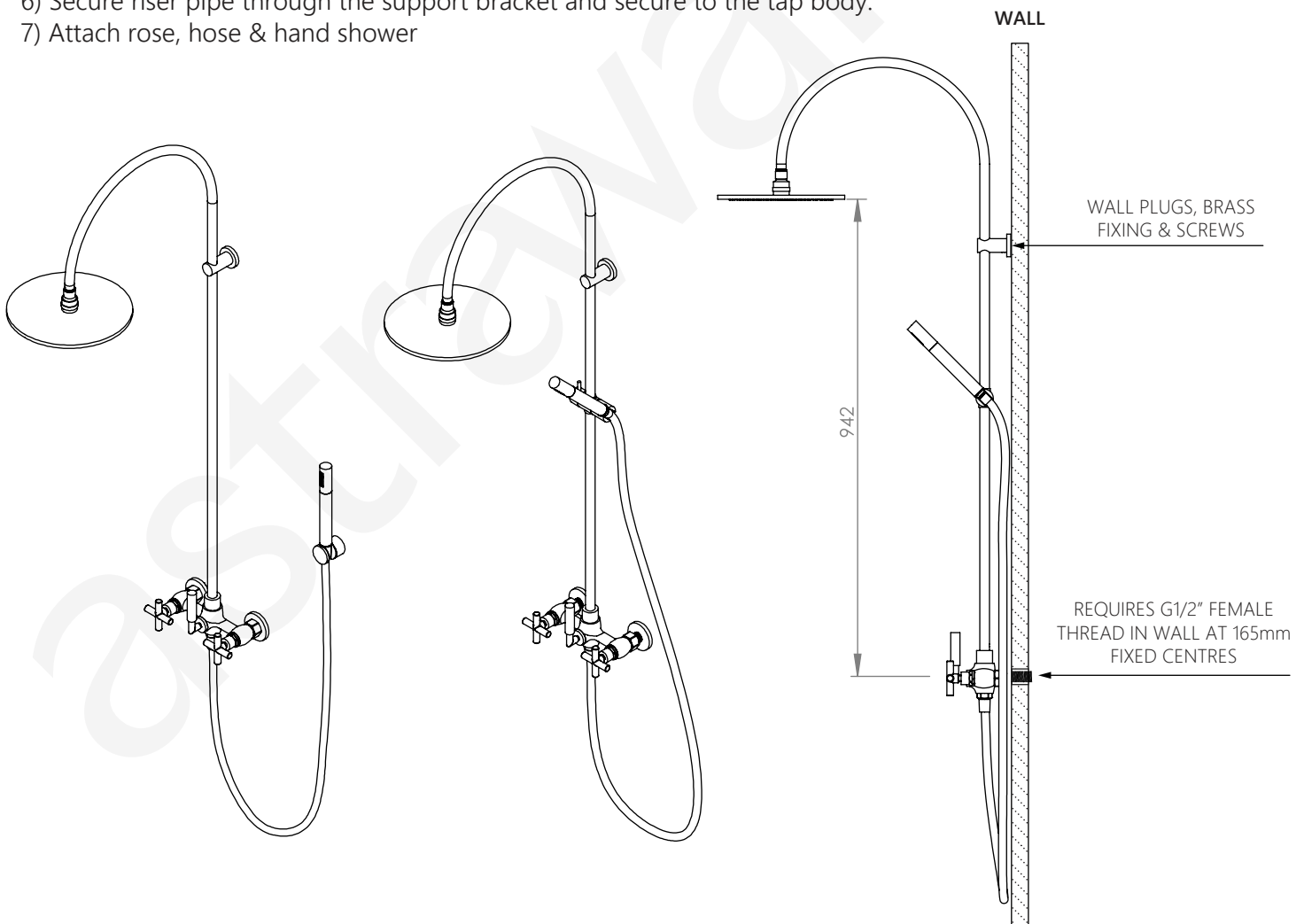

NOTE : The installation of this product must comply with the Australian Plumbing Installation code AS 3500:2021.
Where required, the installer must install a certified dual check valve before the shower hose.

3 STAR/9Lpm WELS RATING

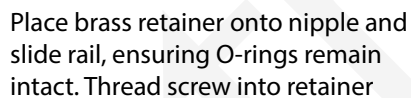

Ensure seal is watertight upon installation. Lock-seal can be applied if required

Slide pillar up rail to required height (covering the join is recommended)

Thread into female
G1/2" fittings

Connect nut to body, ensuring
fibre washers are present

Attach handles using grub screw